

Compatible PCB recommendation

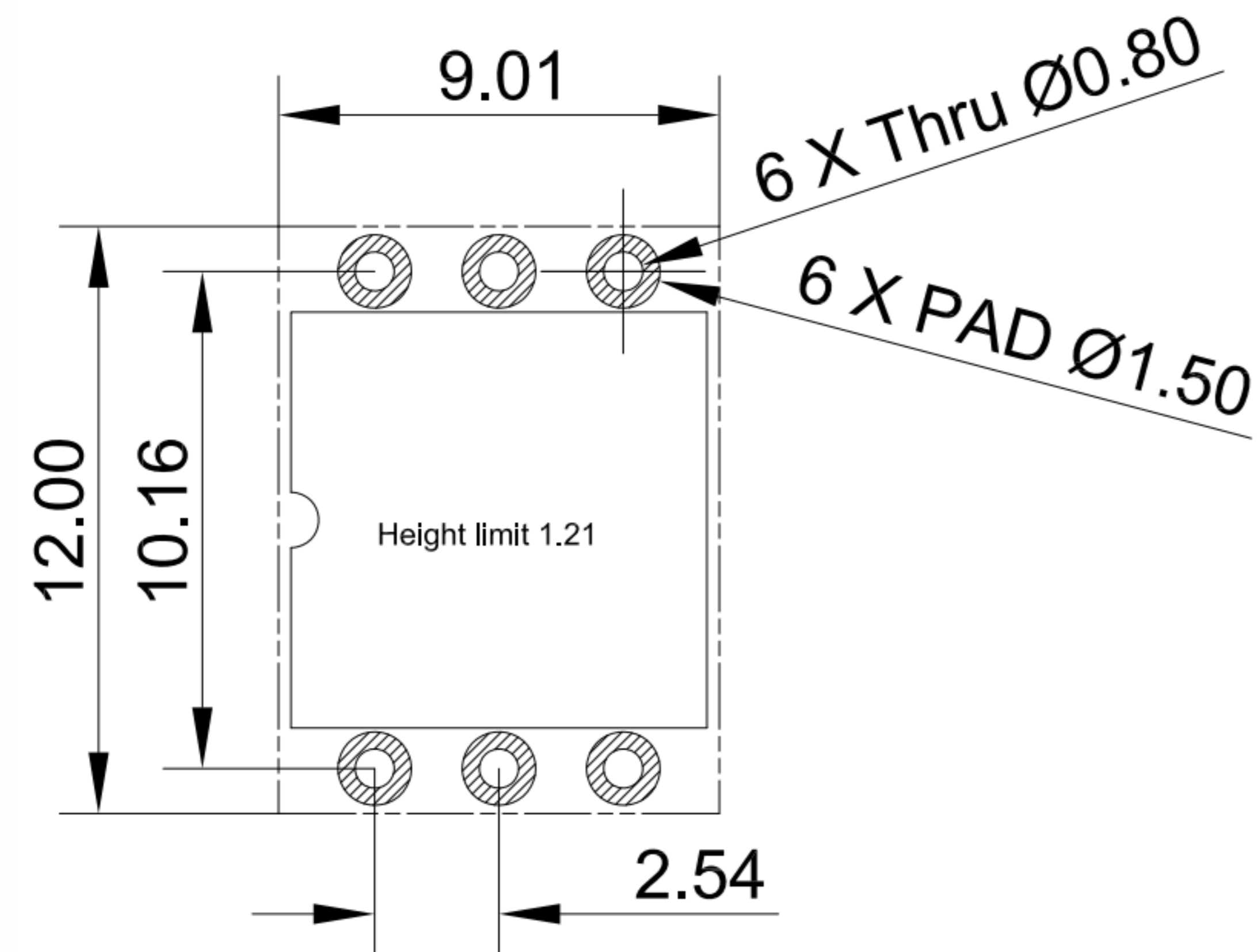

Foot Print

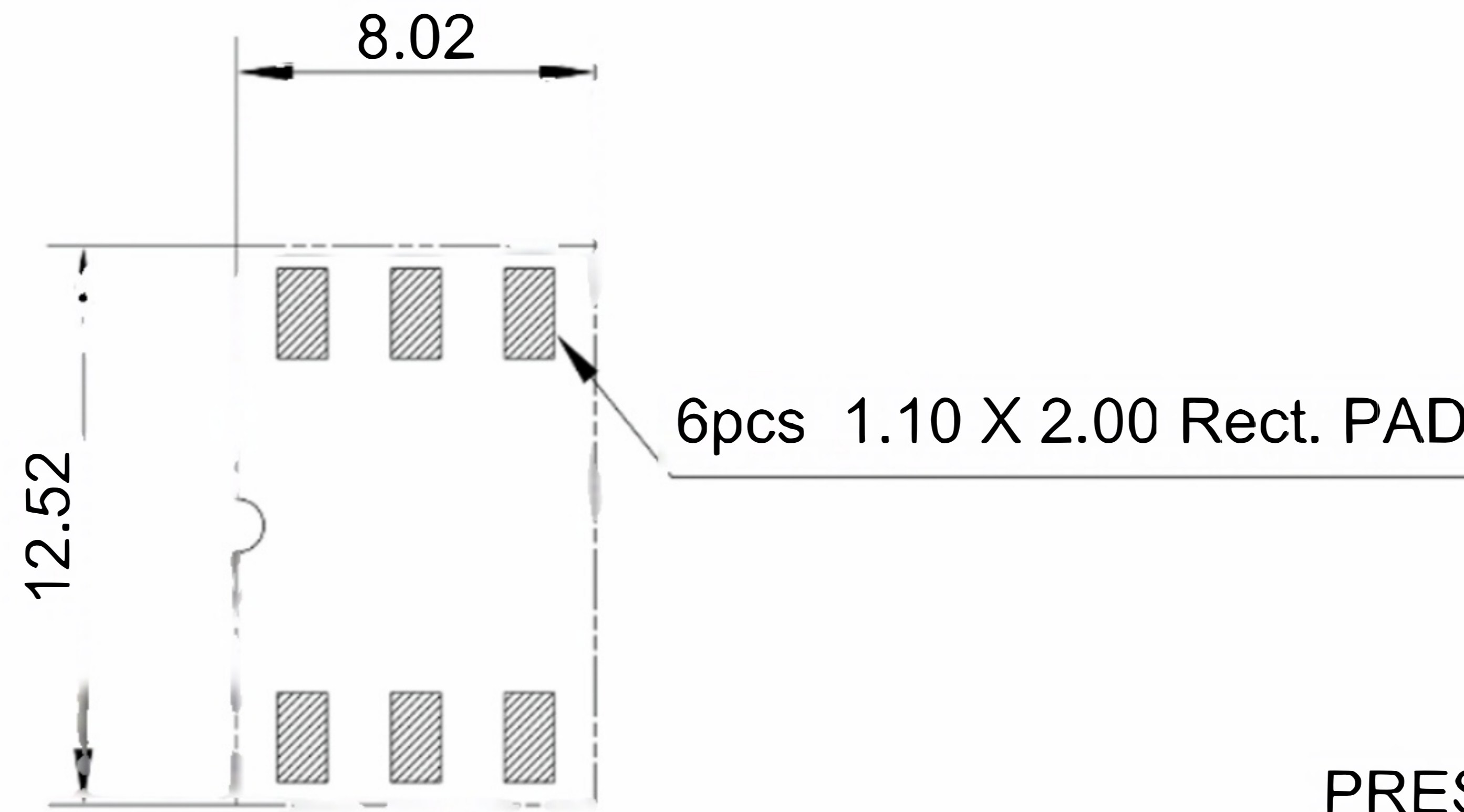
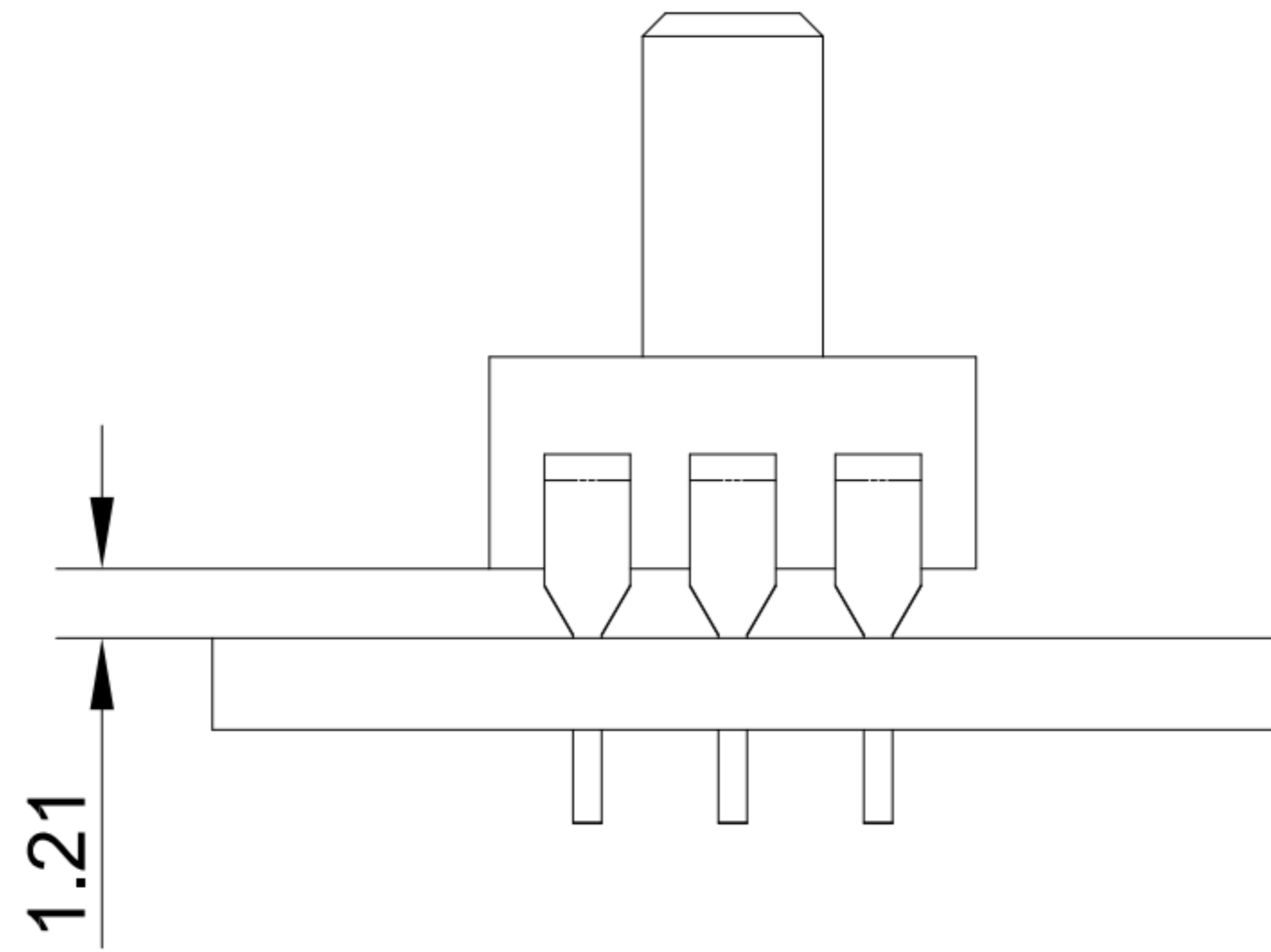

SMT Foot Print

TABLE CONTENTS:

Model :
SA25-G-002-D
lot no
1209090010000
serial no :
00010000001

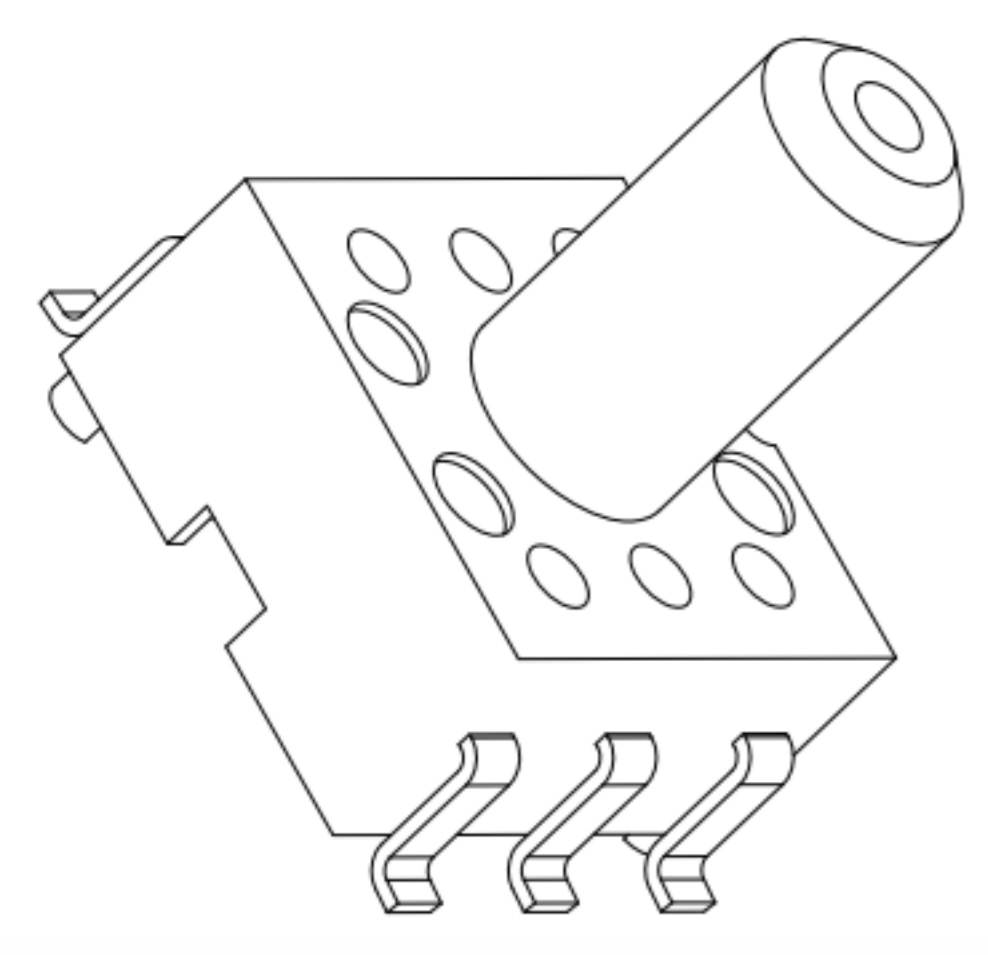
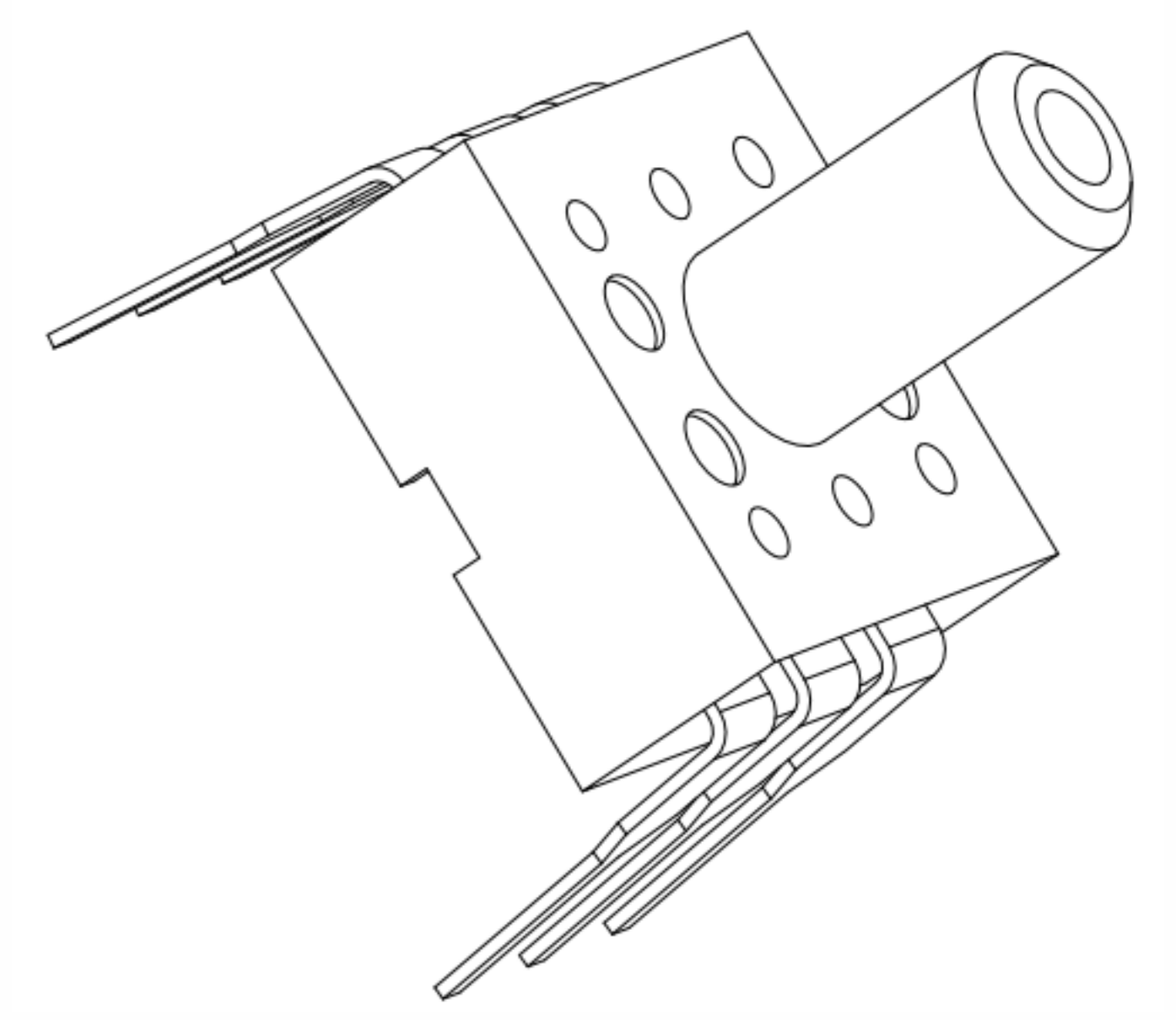
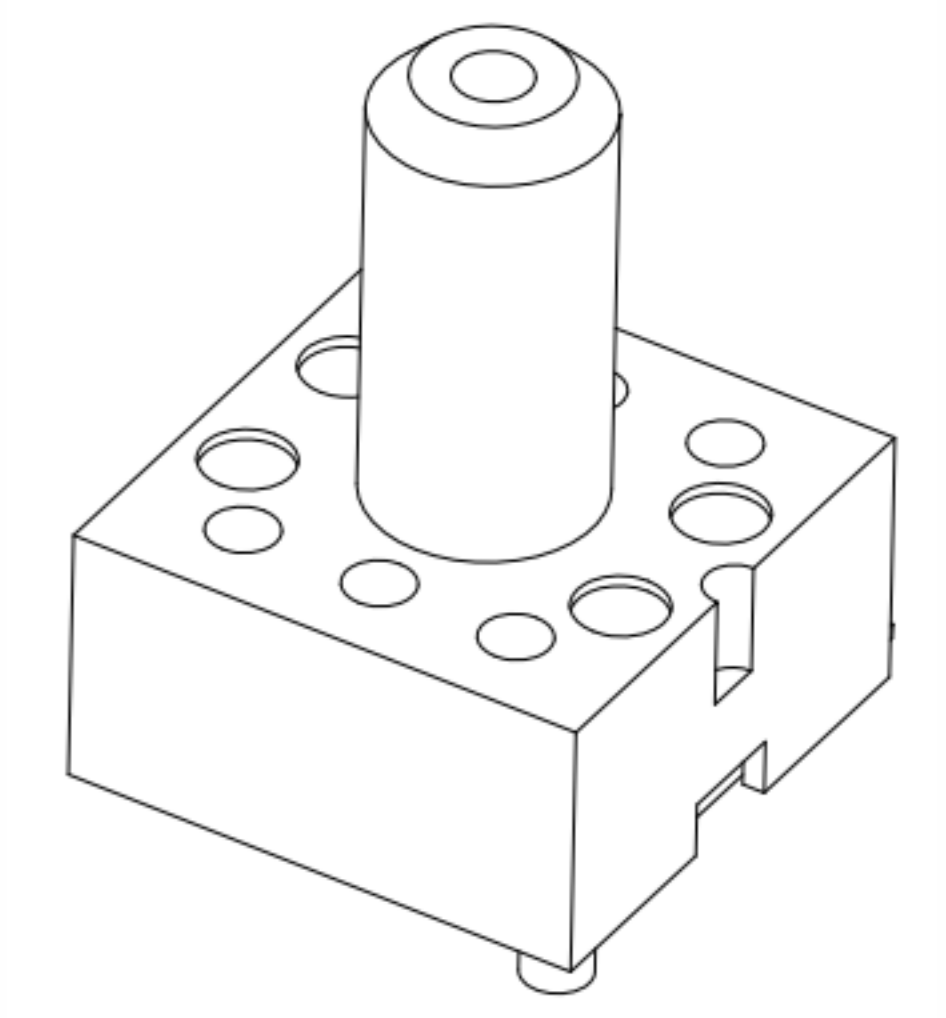

ORDERING INFO

SA25*-***-*

PACKAGING :
D-DIP 7.0x7.0MM
S-SOIC 8.5x8.5MM

PRESSURE REFERENCE
A-Absolute
G-Gage

PRESSURE RANGE :
002-(2 PSI, gage only)
005-(5.8 PSI, gage only)
015-(15 PSI)
030-(30 PSI)
050-(50 PSI)
100-(100 PSI)

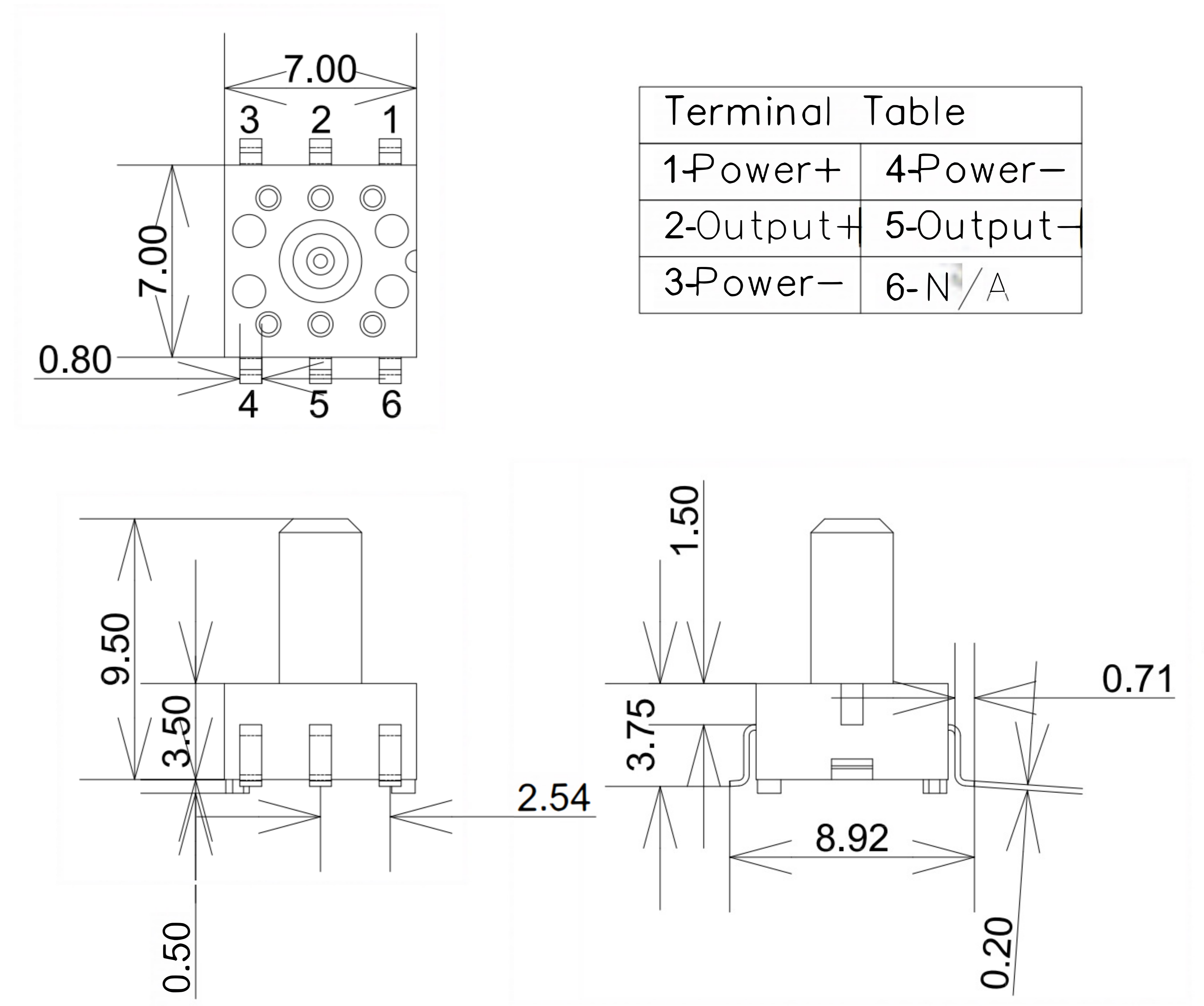
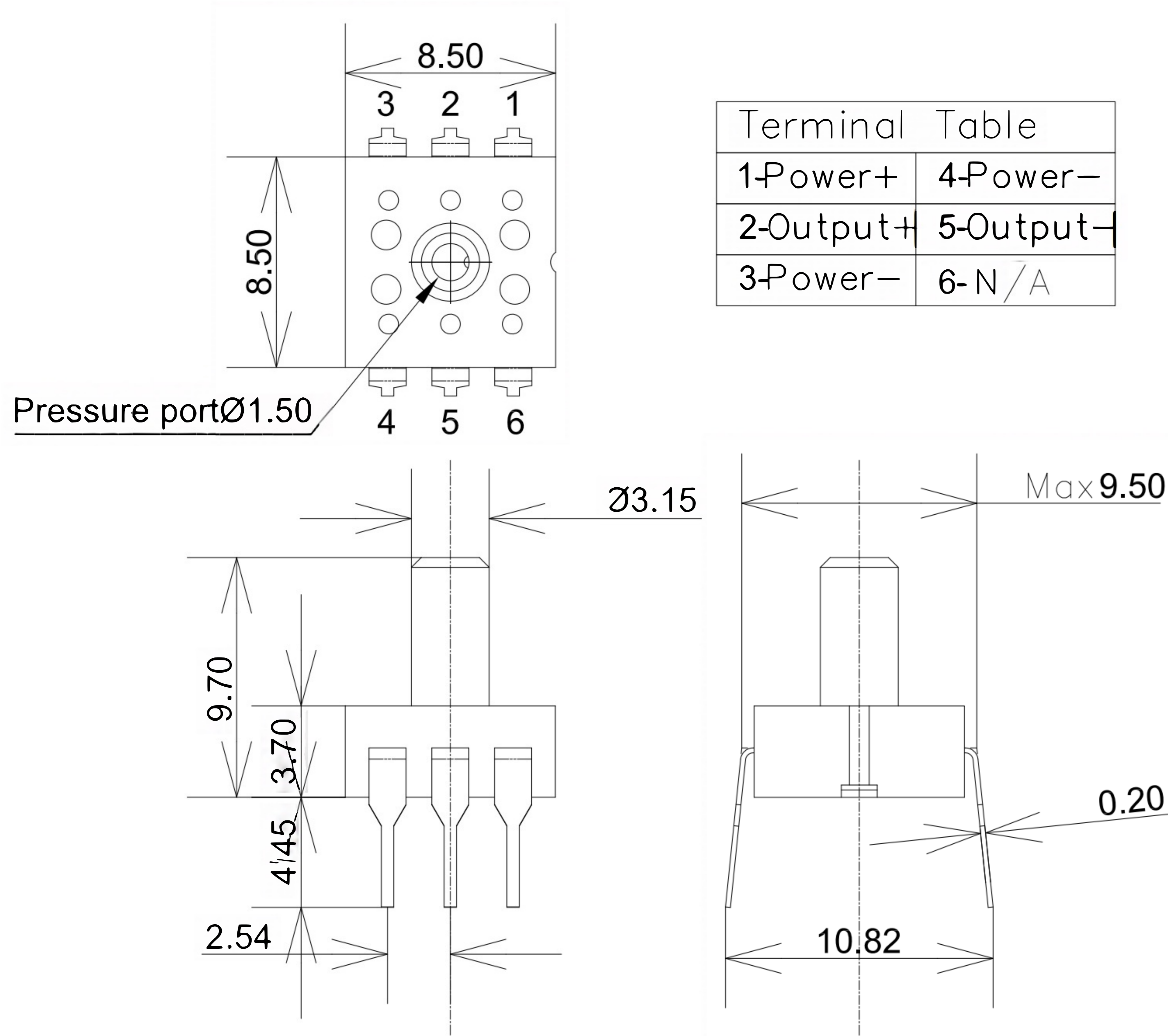

NOTES :

1 , Reference conditions (unless otherwise noted) :
 Supply voltage $V_s=5.0V_{dc}$ $T_a=25^{\circ}C$ [77°F];
 Output signal is ratiometric to the supply voltage.

2 , Temperature Coefficients are typical values between
 -20°C and +100 C

3 , Span is the algebraic difference between the outputs
 at full pressure and zero pressure.
 Span is ratiometric to the power supply.

4, Respons time for 0psi to full scale pressure step
 change, 10 to 90% rise time.

REV A Date: 2020 Feb 19th

PART NUMBERS	PRESSURE RANGE	LINEARITY % SPAN	HYSTERESIS % SPAN	OFFSET (mV)	SPAN (mV)	OVER-PRESSURE (PSI MAX)	RESPONSE TIME (mSEC) MAX	TEMPERATURE COEFFICIENT OF OFFSET (% SPAN / °C)	TEMPERATURE COEFFICIENT OF SPAN (% SPAN / °C)
SA25G-002-*	2 PSI	±0.3	±0.1	±25	40 ±20	15	0.5	+0.07	-0.19
SA25G-005-*	5.8 PSI (300mmHg)	±0.3	±0.1	±25	110 ±40	15	0.5	+0.07	-0.19
SA25G-015-*	15 PSI	±0.3	±0.1	±50	75 ±30	45	0.5	+0.02	-0.19
SA25G-030-*	30 PSI	±0.3	±0.1	±50	80 ±30	90	0.5	+0.02	-0.19
SA25G-050-*	50 PSI	±0.3	±0.1	±50	70 ±25	150	0.5	+0.02	-0.19
SA25G-100-*	100 PSI	±0.3	±0.1	±50	70 ±25	300	0.5	+0.02	-0.19
SA25A-015-*	15 PSI Abs	±0.3	±0.1	±50	75 ±25	45	0.5	+0.02	-0.19
SA25A-030-*	30 PSI Abs	±0.3	±0.1	±50	80 ±30	90	0.5	±0.02	-0.19
SA25A-050-*	50 PSI Abs	±0.3	±0.1	±50	70 ±25	150	0.5	±0.02	-0.19
SA25A-100-*	100 PSI Abs	±0.3	±0.1	±50	70 ±25	300	0.5	±0.02	-0.19

ENVIRONMENTAL SPECIFICATIONS

OPERATING	-40°C to 125°C [-40°F to 257°F]
STORAGE	-40°C to 125°C [-40°F to 257°F]
VIBRATION	10g at 20Hz to 2000Hz
WEIGHT	<1 Gram
LIFE	1 Million cycles minimum
LEAD SOLDER TEMPERATURE (DIP PACKAGE)	Dip in solder bath-Max 250°C (482°F) for 5 seconds
SMT SOLDER (SOIC PACKAGE)	Sn 96.5 Ag 3.5 No clean flux Sn63 Pb37 No clean flux
SMT REFLOW PROFILE (SOIC PACKAGE)	Max peak temperature of 250°C (482°F) for 10 seconds

GENERAL SPECIFICATIONS

	MIN	TYP	MAX	UNITS	REMARK
EXCITATION	2.0	5.0	10.0	Vdc	
i/p & o/p IMPEDANCE	2.8K	3.3K	3.8K	Ohms	for 2 & 5psi range
i/p & o/p IMPEDANCE	3.2K	4.0K	4.8K	Ohms	for 15psi & above